

**Mi • Light<sup>®</sup>**

**Color Temperature Remote Control**

Model No.: FUT006 / FUT007

## 1. Features

This manual describes two types of remote controls with same functions. Adopt world-wide used 2.4GHz frequency, GFSK control method, with the features of low power consumption, long distance transmitting, strong anti-interference and fast communication rate. Can control specified Mi-Light / MiBoxer smart light with color temperature and brightness changing.

## 2. Products Key Diagram

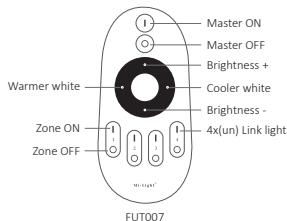
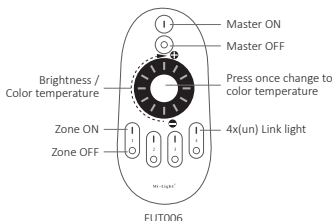

- To dim all dual white lights at once or change the color temperature, first press "Master ON".
- To do this with individual lights, first press "Zone ON". Secondly, set the adjustment for color temperature or brightness.
- To turn on the night light mode of a single (dual white) light, press and hold the "Zone OFF" from one of the 4 Zones.
- To turn on all the lights in night light mode, press and hold "Master OFF".
- For remote control FUT006, the default mode is to adjust the brightness, rotating the wheel from left to right, brightness up, from right to left, brightness down. Switching to adjusting the color temperature by pressing the middle button once, left to right, cooler, right to left, warmer.

### 3. Linking Code / Unlinking Code Instructions

**Remark:** The light can be working after linking with the remote.

#### Linking Code Instructions

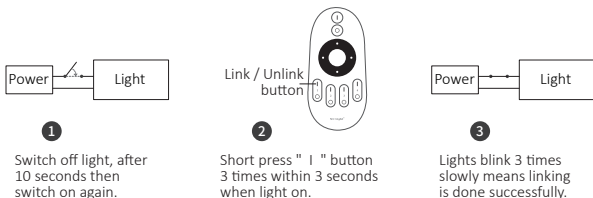

Linking failed if light is not blinking slowly, Please follow above steps again.  
(Note: Light that have linked can't link again)

#### Unlinking Code Instructions

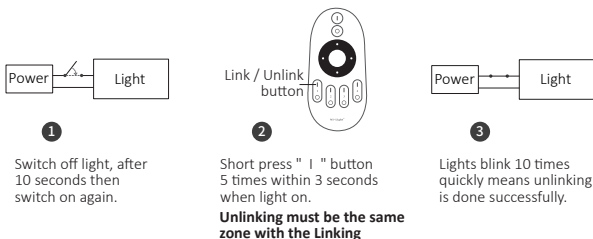

Unlinking failed if light is not blinking quickly, Please follow above steps again.  
(Note: Light haven't linked that don't need to unlink)

## 4. Grouping of several lights

You can add an endless numbers of lights to a zone on the 4 channel remote by linking the lights to different zones. This way you are completely flexible in creating different group combinations. Below you can see some grouping examples.

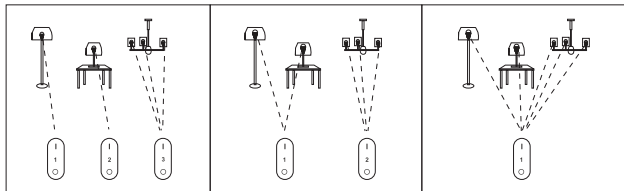

### Remark:

1. The user can re-programme freely as needed. One remote can control countless lamps or controllers, but one lamp or controller can only be controlled by four remotes (Max).
2. Please check the battery installation and controller (totally discharge the power), when you programme after switching off and switching on.

## 5. Attention

1. This remote only control specified Mi-Light / MiBoxer products; not all Mi-Light / MiBoxer series can work on this remote.
2. In the using of the remote, if the indicated lamp blinking quickly, Please change the battery in time. Please don't use poor quality battery to avoid the leaking of battery liquid to damage the remote.
3. This 2.4GHz remote is precise electronic product; don't use it in humid, high temperature, dust and high voltage environment; Saving it at indoor, dry and no static electricity environment.
4. Please don't use the remote on the wide-range metal or strong electromagnetic wave area, otherwise, it will badly affect the controlling distance.



Made in China



## **8-Zone RGB+CCT Remote**

Model No.: FUT089

## 1. Features

This product adopt world-wide used 2.4GHz frequency, GFSK control method, with the features of low power consumption, long distance transmitting, strong anti-interference and fast communication rate. can control specified Mi-Light / MiBoxer smart light with color, color temperature, saturation and brightness changing.

## 2. Products Key Diagram

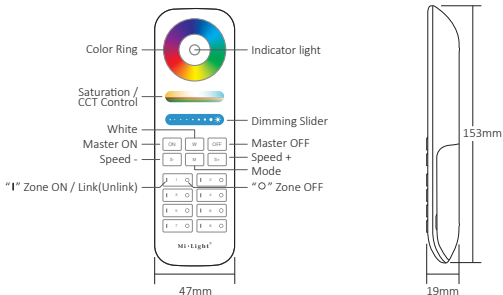

Touch the color ring to change colors.



Under white light mode, adjust color temperature;  
Under color light mode, change color saturation.



Slide the brightness slider to adjust the brightness.



Press the button to get white light.



Touch ON button, turn on the linked device.



Touch OFF button, turn off the linked device.



Dynamic mode switching button.



Accelerate the dynamic mode speed.



Lower the dynamic mode speed.

### 3. Linking Code / Unlinking Code Instructions

**Remark:** The light can be working after linking with the remote.

#### Linking Code Instructions



Linking failed if light is not blinking slowly, Please follow above steps again.  
(Note: Light that have linked can't link again)

#### Unlinking Code Instructions



Unlinking failed if light is not blinking quickly, Please follow above steps again.  
(Note: Light haven't linked that don't need to unlink)

## 4. Grouping of several lights

You can add an endless numbers of lights to a zone on the 8 channel remote by linking the lights to different zones. This way you are completely flexible in creating different group combinations. Below you can see some grouping examples.

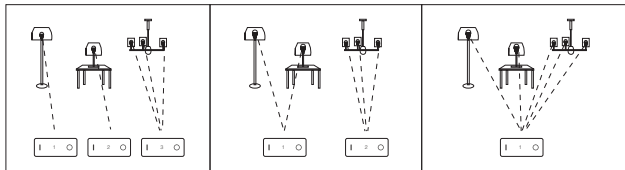

### Remark:

1. The user can re-programme freely as needed. One remote can control countless lamps or controllers, but one lamp or controller can only be controlled by four remotes (Max).
2. Please check the battery installation and controller (totally discharge the power), when you programme after switching off and switching on.

## 5. Attention

1. This remote only control specified Mi-Light / Miboxer products; not all Mi-Light / Miboxer series can work on this remote.
2. In the using of the remote, if the indicated lamp blinking quickly, Please change the battery in time. Please don't use poor quality battery to avoid the leaking of battery liquid to damage the remote.
3. This 2.4GHz remote is precise electronic product; don't use it in humid, high temperature, dust and high voltage environment; Saving it at indoor, dry and no static electricity environment.
4. Please don't use the remote on the wide-range metal or strong electromagnetic wave area, otherwise, it will badly affect the controlling distance.



Made in China





RGB+CCT Remote (Zigbee 3.0)

Model No.: FUT089Z

# 1. Features

This item is made by zigbee 3.0 standard protocol with low consumption, strong ability to set up internet and anti-interference. It can control on/off, RGB color, color temperature, saturation and brightness for zigbee 3.0 lights. One remote device can control max 25 lights.



Zigbee 3.0 standard protocol



Compatible with all zigbee 3.0 lights



7 Zones can divide lights into different combinations easily



16 Millions of colors to choose



Color temperature adjustable



Dim brightness / saturation



Remote support add to the zigbee 3.0 gateway  
Can realize App and remote to control lights



Each zone can keep one favorite color, double click zone "I" key to get it (Need to add remote into zigbee gateway and set up by App)

## 2. Parameters

Model No.: FUT089Z

Working Voltage: 3V (AAA \* 2PCS)

Transmitting Power: 10dBm

Standby Power Consumption: 20 $\mu$ A

Max Controllable Lights: 25 Pcs

Control Distance: 100m (open area)

Working Temperature: -10~40°C

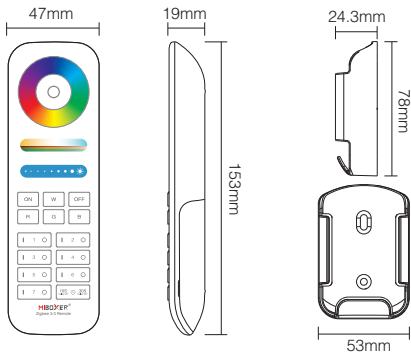

### 3. Function

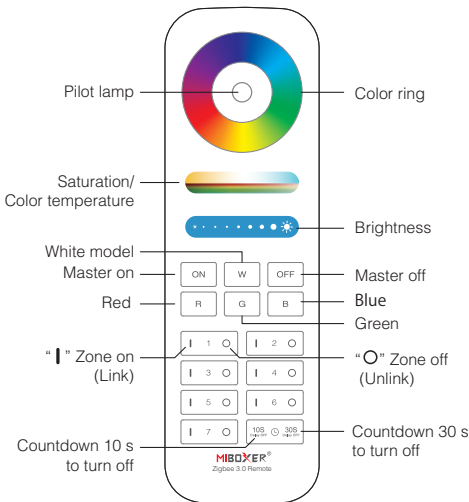

**Attention:** Please change battery if the indicator flashes frequently with low percentage.



Touch the color ring to change colors.



Under white light mode, adjust color temperature;  
Under color light mode, change color saturation.



Slide the brightness slider to adjust the brightness.



Switch to white color model



Master on, turn on all lights which had linked.



Master off, turn off all lights which had linked.

## 4. Link and Unlink (not added into gateway)

### Instruction of Matching

1. Connect light with power supply.
2. Ensure the light is always on ( please wait 5 seconds to turn off light and turn on again if the light is in breathe ambience ).
3. Long press " | " button in zone 3 seconds untill the pilot lamp of remote flash slowly.
4. Make the remote with lights closely ( within 1m).
5. Matching is done if the light breathe 3 times.

### Instruction of Dismatching

1. Connect light with power supply.
2. Ensure the light is always on.
3. Long press zone " O " button with 3 seconds untill the indicator of remote flash quickly
4. Make the remote with lights closely ( within 1m).
5. Dismatching is done if the light breathe 3 times.

## Attention

1. **Please repeat linking if the device don't link successfully after indicator flash 20 seconds.**
2. Remote only match or mismatch with one light in one time, it will match or mismatch with the nearest light.
3. **Remote not added into gateway:** One light is only controlled by one remote.
4. **Remote and light added into same gateway:** One light can be controlled by many remotes.

| Remote                                      | Light   |
|---|---|
| The remote doesn't pair with zigbee gateway | Support match and mismatch light  |
| The remote paired with Zigbee gateway       | Only support match and mismatch light which connected with same gateway |

## 5. Zone Control

It's flexible to creat different zones. Each zone max connect with 25 lights. One remote support connection with 25 lights. One light can be controlled by same remote from different zones.

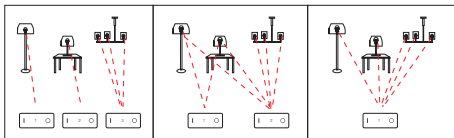

## 6. Add remote into zigbee 3.0 gateway

Zigbee lights can be controlled by remote, app or third party voice at the same time

### Method:

1. "MiBoxer Smart" app already added gateway.
2. Click "zigbee gateway" in "Home" interface and enter in.
3. Add subdevice.

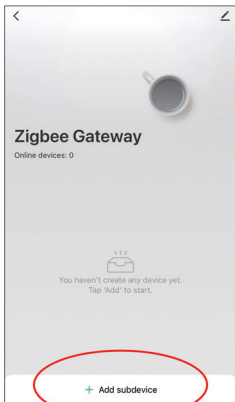
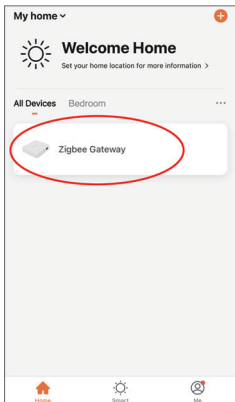

4. Press " **ON** " and " **OFF** " button 5 seconds at the same time untill indicator of remote flash one time with one seconds.
5. Click "Indicator is flashing quickly"

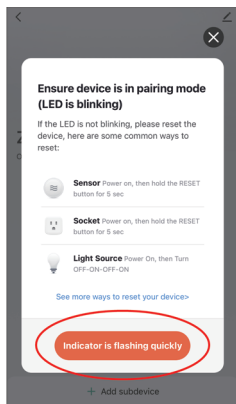



6. Click "Done" ,remote added into gateway successfully

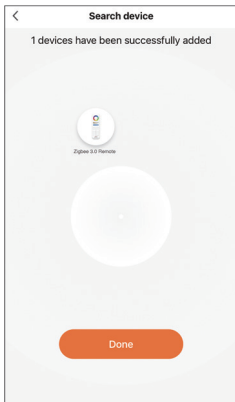

## 7. Match and mismatch light (Remote already added into gateway)

1. "MiBoxer Smart" app already added zigbee 3.0 gateway and some lights connected into zigbee gateway ( please read instruction for zigbee lights and find out solution for matching and mismatching).
2. Select "Zigbee Remote" and enter in.
3. Select zone which need to match or mismatch (eg:zone-1).

**Attention: "ON/OFF" need to match or mismatch manually.**

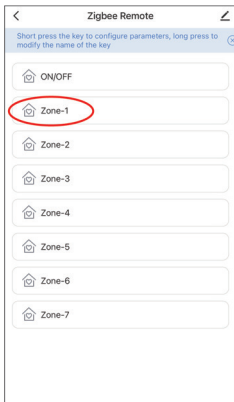
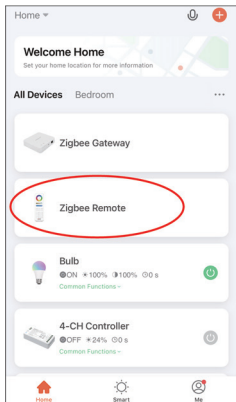

4. Click "Device Selection"

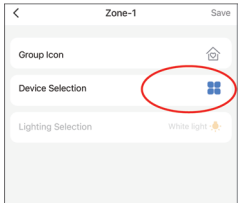

5. Click select the controlled device and "Save"

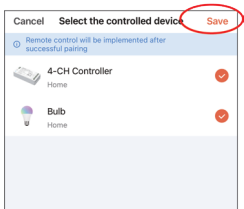

6. "Lighting Selection" instruction:

a). Select Color or Scene you like, click "Save".

b). Double click "I" on the remote to quickly change the light to the color of your choice.

7. Set up completed and click "Save" it

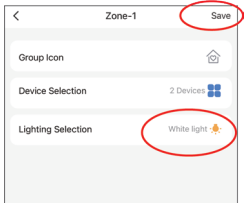

## 8. Attention

1. Please change battery if the indicator of remote flash frequently while you are using it. Don't use battery with poor quality, otherwise the battery is easy to liquid out and broke remote
2. Please don't use it in moist, high temperature,dusty or high voltage application since this model is accurate electronics.We suggest to keep it indoor,dry and none static electricity area
3. Please stay away from wide metal and high magnetic field, otherwise it will affect transmitting distance.



Made in China