

ROADMASTER S

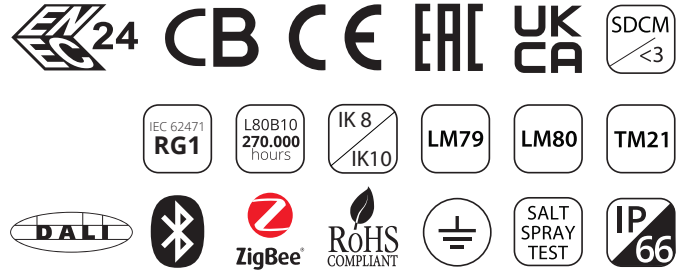

RAL 7037

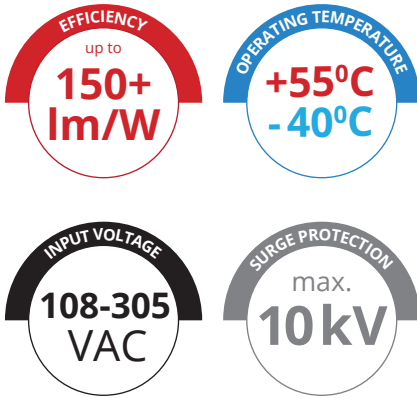

Specifications

- IP66 protection
- Aluminium injection body
- Engineered to operate in harsh and hot conditions
- Over **60.000** hours life according to LM80 and TM21 standard
- Up to **150+** lm/W efficiency
- **108-305VAC** input voltage range against voltage fluctuation
- **10kV** surge protection
- **-40°C / +55°C** operating temperature
- Aluminum PCB (2,0 W/mK)
- SMD PCB connector
- Special silicone gasket
- Brass cable gland and brass ventilation valve
- Photometric solutions for different road applications
- Measurements according to EN 60598-1 standards
- Photometric measurements according to IESNA-LM-79-08

Application Areas

- ME3 - ME4 - ME5 Class Street Lighting
- Park & Garden

Optional

- Marine protective coating
- 4 pins ZHAGA socket options
- Toolless access to the driver compartment
- Power cut if the power unit cover is opened
- Sensor, dimming, wireless communication features
- I-10V, DALI automation integration

Beam Angles

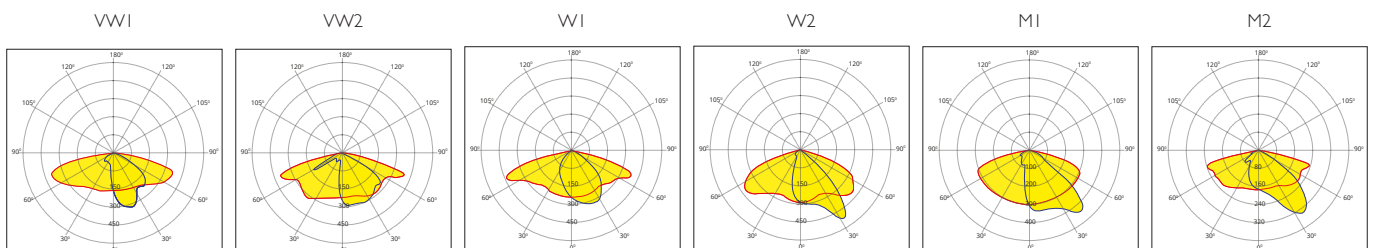

Dimensions

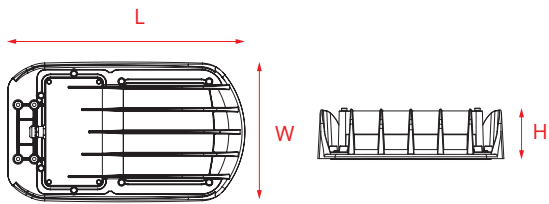

Mounting Bracket
(Standard)

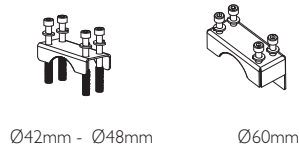

Tiltable mounting bracket is optional. According to the pole diameter, an additional bracket suitable for 48/60 mm diameter should be ordered.

Mounting Options

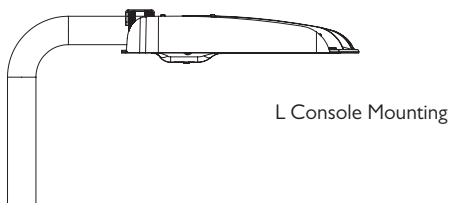

Tiltable mounting bracket
(Opsiyonel / Optional)

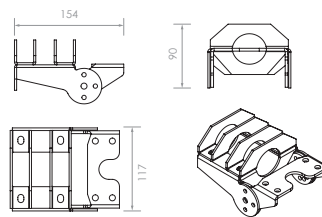

Tiltable mounting bracket is only for pole mounting

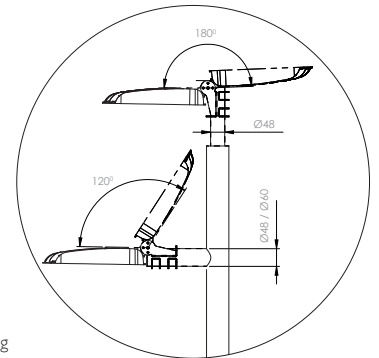

Product Photos

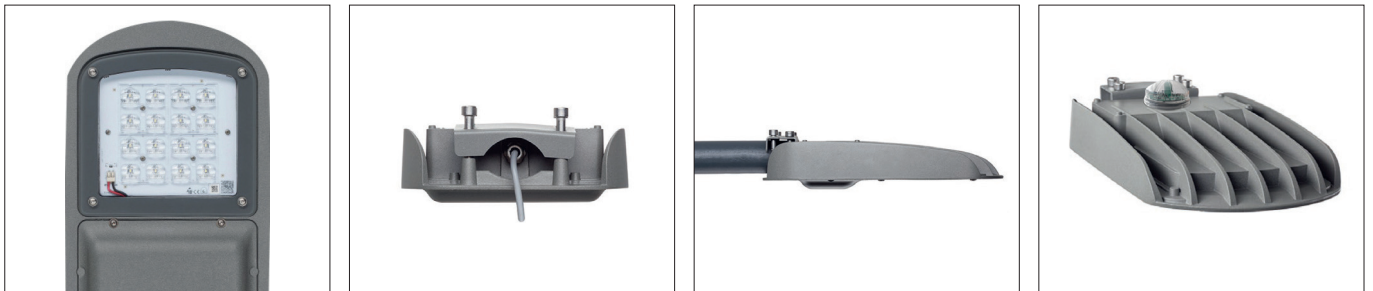

Roadmaster S

		W	lm	lm/W	LED	▲	K	AC	CRI	IP	L (mm)	W (mm)	H (mm)	gr.
MP*	AL-MM36	36	5395	150	NICHIA / LUMILEDS SEOUL	M1	4000	108-305VAC	>70	IP66	350	206	57	3100
	AL-HM50	50	6513	130	NICHIA / LUMILEDS SEOUL	120°	4000	108-305VAC	>70	IP66	350	206	57	3100
	AL-HM56	56	7574	135	NICHIA / LUMILEDS SEOUL	M1	4000	108-305VAC	>70	IP66	350	206	57	3100
HP*	AL-S1 H52	52	5947	114	NICHIA / SAMSUNG LUMILEDS / SEOUL	M1	4000	108-305VAC	>70	IP66	350	206	57	3100
	AL-S6 H70	70	8964	128	NICHIA / LUMILEDS SEOUL	M1	4000	108-305VAC	>70	IP66	350	206	57	3100
	AL-S7 H75	75	9380	125	NICHIA / LUMILEDS SEOUL	M1	4000	108-305VAC	>70	IP66	350	206	57	3100

Power and lumen values are within ± 5% tolerance.

Lumen Multiplier Table

CRI	3000K	4000K	5000K	6500K
70	0,95	1,00	1,00	0,97
80	0,88	0,95	0,95	0,93
90	0,75	0,80	0,80	0,80

* High Power LED Series

* Mid Power LED Series