

## SAVER COMPACT HBM PLUS

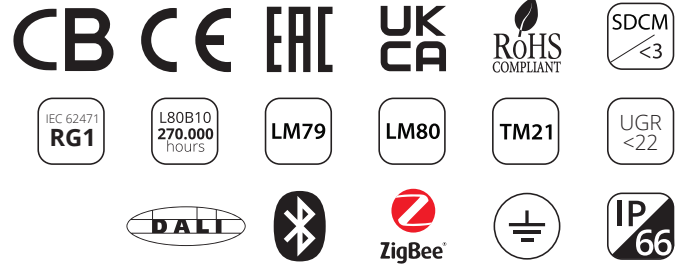

RAL 9005

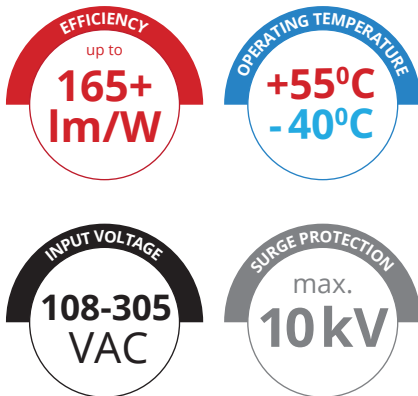

### Specifications

- IP66 protection
- Engineered to operate in harsh and hot conditions
- Over **60.000** hours life according to LM80 and TM21 standard
- Up to **165+ lm/W** efficiency
- **108-305VAC** input voltage range against voltage fluctuation
- **10kV** surge protection
- Special design 6063 aluminium extrusion cooling system
- **-40°C / +55°C** operating temperature
- Aluminum PCB (2,0 W/mK)
- SMD PCB connector
- Special silicone gasket
- Brass cable gland and brass ventilation valve
- Multiple mounting options
- Measurements according to EN 60598-1 standards
- Photometric measurements according to IESNA-LM-79-08

### Application Areas

- Industrial Plant Lighting
- Warehouse Lighting
- Area Lighting
- Sports Center Lighting

### Optional

- Sensor, dimming, wireless connection features
- 1-10V, DALI automation integration
- Emergency mode

### Beam Angles

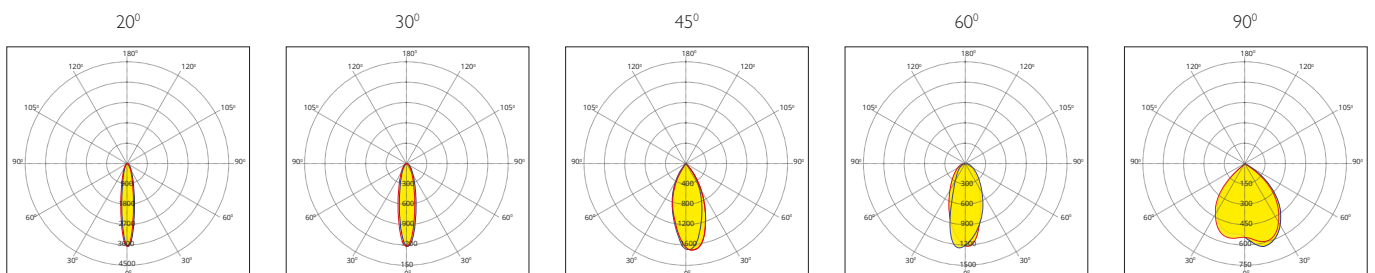



Dimensions

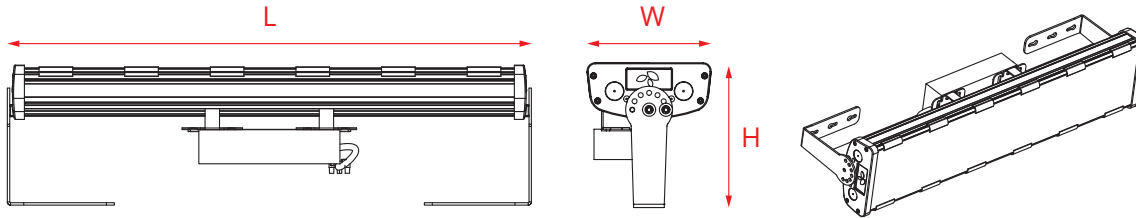

Mounting Options

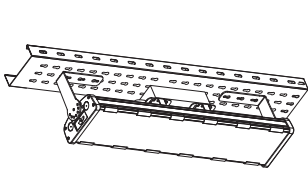

Cable Tray Mounted

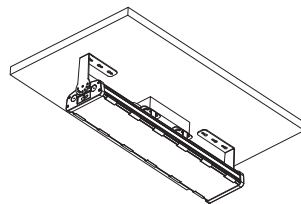

Ceiling Mounted

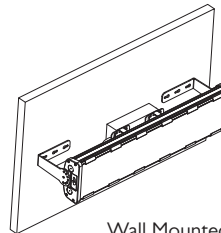

Wall Mounted

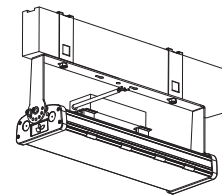

Busbar Mounted

Product Photos



Saver Compact HBM Plus

W	lm	lm/W	lm	lm/W	lm	lm/W	LED	K	AC	CRI	IP	L (mm)	W (mm)	H (mm)	gr.
---	----	------	----	------	----	------	-----	---	----	-----	----	--------	--------	--------	-----

		▲20°		▲30°		▲45°/60°/90°											
L SERIES	AL-HBM PLUS L70	70	11555	165	10729	153	11463	164	LUMILEDS / NICHIA SEOUL	4000	108-305VAC	>70	IP66	476	150	176	4860
	AL-HBM PLUS L90	90	14617	162	13572	151	14500	161	LUMILEDS / NICHIA SEOUL	4000	108-305VAC	>70	IP66	476	150	176	4860
	AL-HBM PLUS L117	117	18740	160	17400	149	18590	159	LUMILEDS / NICHIA SEOUL	4000	108-305VAC	>70	IP66	476	150	176	4860
	HAL-BM PLUS L139	139	22249	160	20658	149	22071	159	LUMILEDS / NICHIA SEOUL	4000	108-305VAC	>70	IP66	662	150	176	6291
	AL-HBM PLUS L175	175	27530	157	25562	146	27310	156	LUMILEDS / NICHIA SEOUL	4000	108-305VAC	>70	IP66	662	150	176	6291
M	AL-HBM PLUS L192	192	30178	157	28020	146	29936	157	LUMILEDS / NICHIA SEOUL	4000	108-305VAC	>70	IP66	662	150	176	6291
	AL-HBM PLUS M242	242	36991	153	34347	142	36695	152	LUMILEDS / NICHIA SEOUL	4000	108-305VAC	>70	IP66	662	150	176	6291
H SERIES	AL-HBM PLUS H96	96	14450	151	13417	140	14335	149	LUMILEDS / NICHIA SEOUL	4000	108-305VAC	>70	IP66	476	150	176	4860
	AL-HBM PLUS H106	106	-	-	-	-	14324	135	LUMILEDS / NICHIA SEOUL	4000	108-305VAC	>70	IP66	662	150	176	6291
	AL-HBM PLUS H148	148	22232	150	20643	139	22054	149	LUMILEDS / NICHIA SEOUL	4000	108-305VAC	>70	IP66	662	150	176	6291

Power and lumen values are within ± 5% tolerance.

Lumen Multiplier Table

CRI	3000K	4000K	5000K	6500K
70	0,95	1,00	1,00	0,97
80	0,88	0,95	0,95	0,93
90	0,75	0,80	0,80	0,80